

- Notes:**
1. All measurements in metres unless otherwise stated
 2. This drawing is to be read in conjunction with all relevant drawings and specification, which is the S.H.W with LBL's amendments & project specific appendices
 3. All dimensions and levels are to be checked by the contractor prior to commencement of work. Any discrepancy shall be reported immediately to Lambeth Council (LBL)
 4. Existing topographical information is taken from CAD files 15227-15-01 & 16031-16-01 produced by SV Surveying Ltd in February 2016
 5. The contractor shall issue TM proposals to the highways authority for approval prior to commencement of the works and maintain all necessary diversion routes during construction
 6. The contractor shall provide traffic management in accordance with Chapter 8 part 1 & 2 Traffic Signs Manual, Safety at Street Works and Road Works Code of Practice 2013. All traffic management proposals shall be approved the highways authority
 7. The contractor shall maintain private and public access at all times
 8. Diversion or abandonment of existing utility networks shall be carried out prior to commencement of works. Liaison with utility companies shall be organised by the contractor
 9. Prior to construction, relevant statutory undertakers' equipment information is to be obtained by the contractor, where applicable proposed excavation areas are to be surveyed using ground penetration radar

- Drawing Status:**
These drawings have been produced with reference to the CDM Regulations 2015, Regulation 9.
- These Drawings are for planning approvals and are not to be used for construction purposes. It is the responsibility of the contractor and client to identify risks associated with the construction stage and to design appropriate measures to mitigate. The risks identified on the PJA Scheme Design Risk Assessment are based on the information available at the time of the design (drawing date) Where shown on PJA Design Drawings, the position of services is based on information provided by other parties at the time of the design and is for guidance only. It is the responsibility of the Client and Contractor to verify the exact position of any services before commencing works on site.
- Client Duties:**
The client is directed to Regulation 4 of the CDM 2015 Regulations: Client duties in relation to managing projects
- Raised table at flush kerb height, see relevant Kerbs, Footways & Paving drawing for details
 - Raised table with 25mm kerb up-stand, see relevant Kerbs, Footways & Paving drawing for details
 - Resurfacing, see relevant Kerbs, Footways & Paving drawing for details
 - Footway & cross-over block paving, see relevant Kerbs, Footways & Paving drawing for details
 - Asphalt footway, see relevant Kerbs, Footways & Paving drawing for details
 - Red Blister tactile paving, see relevant Kerbs, Footways & Paving drawing for details
 - Buff Blister tactile paving, see relevant Kerbs, Footways & Paving drawing for details
 - Granite kerb, see relevant Kerbs, Footways & Paving drawing for details
 - Dropped kerb, see relevant Kerbs, Footways & Paving drawing for details
 - Precast concrete channel, see relevant Kerbs, Footways & Paving drawing for details
 - Marshall's Keybloc (Natural), see relevant Kerbs, Footways & Paving drawing for details
 - Buff resin based high skid resistant surface treatment, see relevant sign and line drawing for details
 - White thermoplastic road marking, see relevant sign and line drawing for details
 - Primrose line marking, see relevant sign and line drawing for details
 - Top soil, see relevant Kerbs, Footways & Paving drawing for details
 - Existing service cover to be raised/lowered, see relevant Kerbs, Footways & Paving drawing for details
 - Replace existing service cover with recess cover & frame, see relevant Kerbs, Footways & Paving drawing for details
 - Carriageway gully / footway gully, see relevant Drainage drawing for details
 - Existing gully
 - Existing lamp column
 - Existing Tree
 - Supply & plant tree (tree species specified by borough arboriculturist) Tree guard as per standard drawing LoHAC 4000.10
 - Supply & install Signature Dura Flex & foundation cage with 'keep left' sign dia. 610 (Ø 270mm) as per standard drawing LoHAC 4000.13 (Non-illuminated)
 - Supply & install Furnitubes half bell bollard (120kg) Bell, top coat to be added onsite following installation as per standard drawing LoHAC 4000.01
 - Supply & install Belisha Beacons standard globe and column (BS EN 1469) to TSRGD 2016 diagram no. 4007. Installation as per manufacturer's specifications

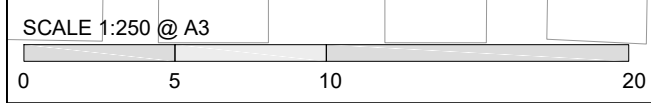

Rev / Date	Description	Dm	Chk'd
 PHIL JONES ASSOCIATES <small>transport planning consultants</small> Unit 16 The Aquarium, 1-7 King Street, Reading, RG1 2AN Tel: 01189560909 reading@philjonesassociates.co.uk www.philjonesassociates.co.uk			
Client			
Sustrans			
Project			
Quietway 07 Lambeth - Detailed Design			
Drawing			
Rosendale Rd - Tritton Rd General Arrangement Sheet 01 of 11			
Drawn by: JMQ _{28/09/2016}	Scale:	1:250 @ A3	
Checked by: SUS _{28/10/2016}			
Drawing No. Q7-D-GA-13-00-01	Revision -		
© Crown copyright and database rights 2015 Ordnance Survey 100035971 / 0159			

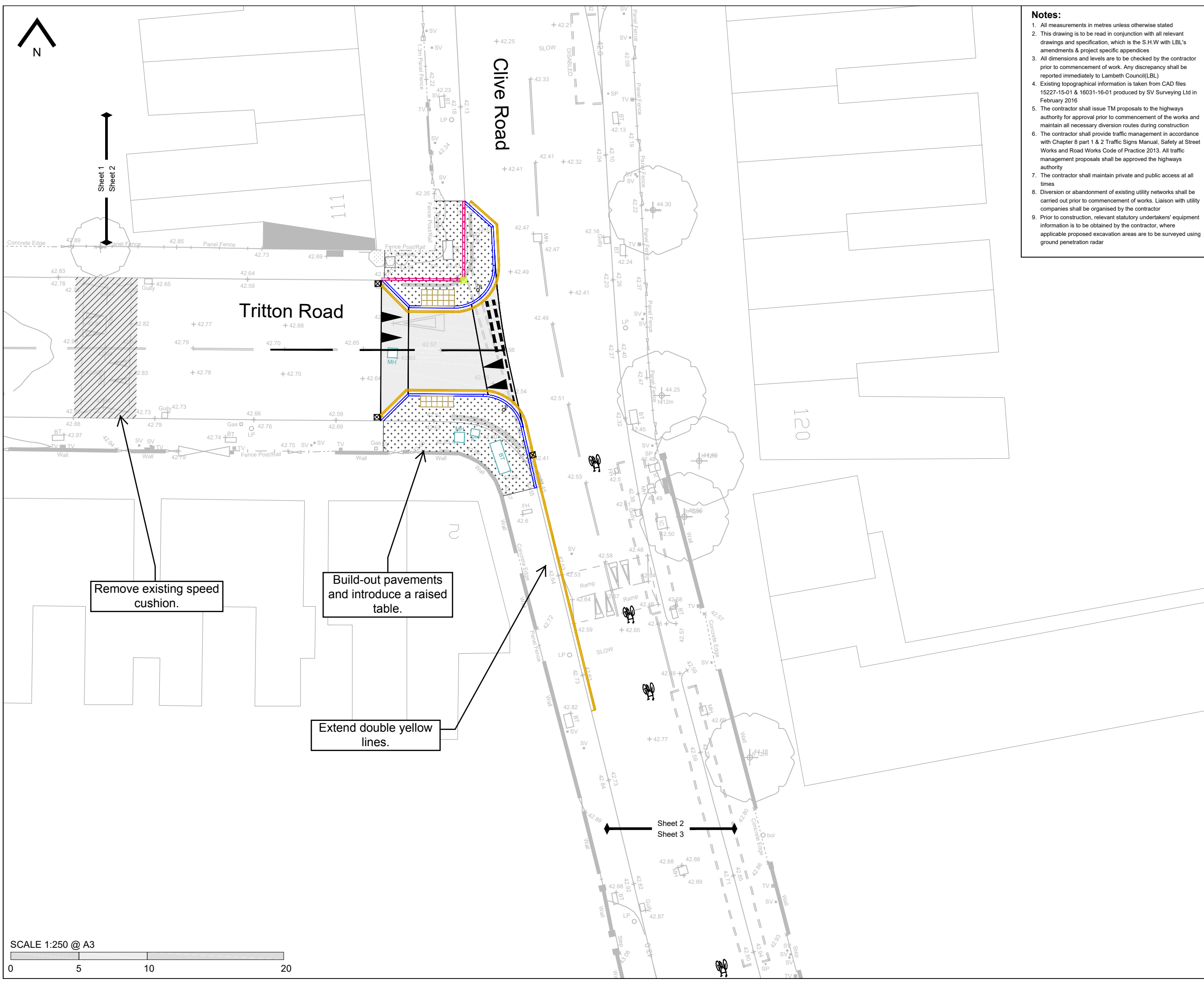

- Notes:**
1. All measurements in metres unless otherwise stated
 2. This drawing is to be read in conjunction with all relevant drawings and specification, which is the S.H.W with LBL's amendments & project specific appendices
 3. All dimensions and levels are to be checked by the contractor prior to commencement of work. Any discrepancy shall be reported immediately to Lambeth Council(LBL)
 4. Existing topographical information is taken from CAD files 15227-15-01 & 16031-16-01 produced by SV Surveying Ltd in February 2016
 5. The contractor shall issue TM proposals to the highways authority for approval prior to commencement of the works and maintain all necessary diversion routes during construction
 6. The contractor shall provide traffic management in accordance with Chapter 8 part 1 & 2 Traffic Signs Manual, Safety at Street Works and Road Works Code of Practice 2013. All traffic management proposals shall be approved the highways authority
 7. The contractor shall maintain private and public access at all times
 8. Diversion or abandonment of existing utility networks shall be carried out prior to commencement of works. Liaison with utility companies shall be organised by the contractor
 9. Prior to construction, relevant statutory undertakers' equipment information is to be obtained by the contractor, where applicable proposed excavation areas are to be surveyed using ground penetration radar

- Drawing Status:**
These drawings have been produced with reference to the CDM Regulations 2015, Regulation 9.
- These Drawings are for planning approvals and are not to be used for construction purposes. It is the responsibility of the contractor and client to identify risks associated with the construction stage and to design appropriate measures to mitigate. The risks identified on the PJA Scheme Design Risk Assessment are based on the information available at the time of the design (drawing date) Where shown on PJA Design Drawings, the position of services is based on information provided by other parties at the time of the design and is for guidance only. It is the responsibility of the Client and Contractor to verify the exact position of any services before commencing works on site.
- Client Duties:**
The Client is directed to Regulation 4 of the CDM 2015 Regulations: Client duties in relation to managing projects
- Raised table at flush kerb height, see relevant Kerbs, Footways & Paving drawing for details
 - Resurfacing, see relevant Kerbs, Footways & Paving drawing for details
 - Asphalt footway, see relevant Kerbs, Footways & Paving drawing for details
 - Buff Blister tactile paving, see relevant Kerbs, Footways & Paving drawing for details
 - Granite kerb, see relevant Kerbs, Footways & Paving drawing for details
 - Precast concrete channel, see relevant Kerbs, Footways & Paving drawing for details
 - White thermoplastic road marking, see relevant sign and line drawing for details
 - Primrose line marking, see relevant sign and line drawing for details
 - Existing service cover to be raised/lowered, see relevant Kerbs, Footways & Paving drawing for details
 - Carriageway gully / footway gully, see relevant Drainage drawing for details
 - Existing gully
 - Existing lamp column
 - Existing Tree

Remove existing speed cushion.

Build-out pavements and introduce a raised table.

Extend double yellow lines.

Sheet 2
Sheet 3

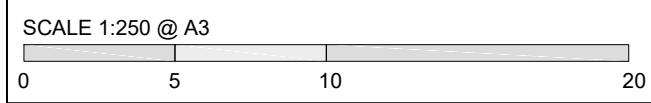

Rev / Date	Description	Drm	Chk'd
 PHIL JONES ASSOCIATES <small>transport planning consultants</small> Unit 16 The Aquarium, 1-7 King Street, Reading, RG1 2AN Tel: 01189560909 reading@philjonesassociates.co.uk www.philjonesassociates.co.uk			
Client			
Sustrans			
Project			
Quietway 07 Lambeth - Detailed Design			
Drawing			
Tritton Rd - Clive Rd General Arrangement Sheet 02 of 11			
Drawn by: JMQ _{28/09/2016}		Scale:	
Checked by: SUS _{28/10/2016}		1:250 @ A3	
Drawing No.		Revision	
Q7-D-GA-14-00-01		-	
<small>© Crown copyright and database rights 2015 Ordnance Survey 100035971 / 0159</small>			