

- Notes:**
1. All measurements in metres unless otherwise stated
  2. This drawing is to be read in conjunction with all relevant drawings and specification, which is the S.H.W with LBL's amendments & project specific appendices
  3. All dimensions and levels are to be checked by the contractor prior to commencement of work. Any discrepancy shall be reported immediately to Lambeth Council (LBL)
  4. Existing topographical information is taken from CAD files 15227-15-01 & 16031-16-01 produced by SV Surveying Ltd in February 2016
  5. The contractor shall issue TM proposals to the highways authority for approval prior to commencement of the works and maintain all necessary diversion routes during construction
  6. The contractor shall provide traffic management in accordance with Chapter 8 part 1 & 2 Traffic Signs Manual, Safety at Street Works and Road Works Code of Practice 2013. All traffic management proposals shall be approved by the highways authority
  7. The contractor shall maintain private and public access at all times
  8. Diversion or abandonment of existing utility networks shall be carried out prior to commencement of works. Liaison with utility companies shall be organised by the contractor
  9. Prior to construction, relevant statutory undertakers' equipment information is to be obtained by the contractor, where applicable proposed excavation areas are to be surveyed using ground penetration radar

White thermoplastic road marking, see relevant sign and line drawing for details

No changes proposed to Clive Road on this section.

Rev	Date	Description	Drawn	Chk'd

**Drawing Status:**  
These drawings have been produced with reference to the CDM Regulations 2015; Regulation 9.

These Drawings are not to be used for construction purposes. It is the responsibility of the contractor and client to identify risks associated with the construction stage and to design appropriate measures to mitigate. The risks identified on the PJA Scheme Design Risk Assessment are based on the information available at the time of the design (drawing date) Where shown on PJA Design Drawings, the position of services is based on information provided by other parties at the time of the design and is for guidance only. It is the responsibility of the Client and Contractor to verify the exact position of any services before commencing works on site.

**Client Duties:**  
The client is directed to Regulation 4 of the CDM 2015 Regulations: Client duties in relation to managing projects.

Client  
**Sustrans**

Project  
**Quietway 07  
Lambeth - Detailed Design**

Drawing  
**Clive Road  
General Arrangement  
Sheet 03 of 11**

**PHIL JONES ASSOCIATES**  
transport planning consultants

Unit 16 The Aquarium, 1-7 King Street,  
Reading, RG1 2AN  
Tel: 01189560909  
reading@philjonesassociates.co.uk  
www.philjonesassociates.co.uk

Drawn by: JMQ<sub>17/11/2016</sub> Scale: 1:500 @ A3  
Checked by: XX<sub>XX/XX/XXXX</sub>

Drawing No. **Q7-D-GA-15-00-01** Revision -

Ordnance Survey (c) Crown Copyright 2014.  
All rights reserved. Licence number xxxxxxxxxx

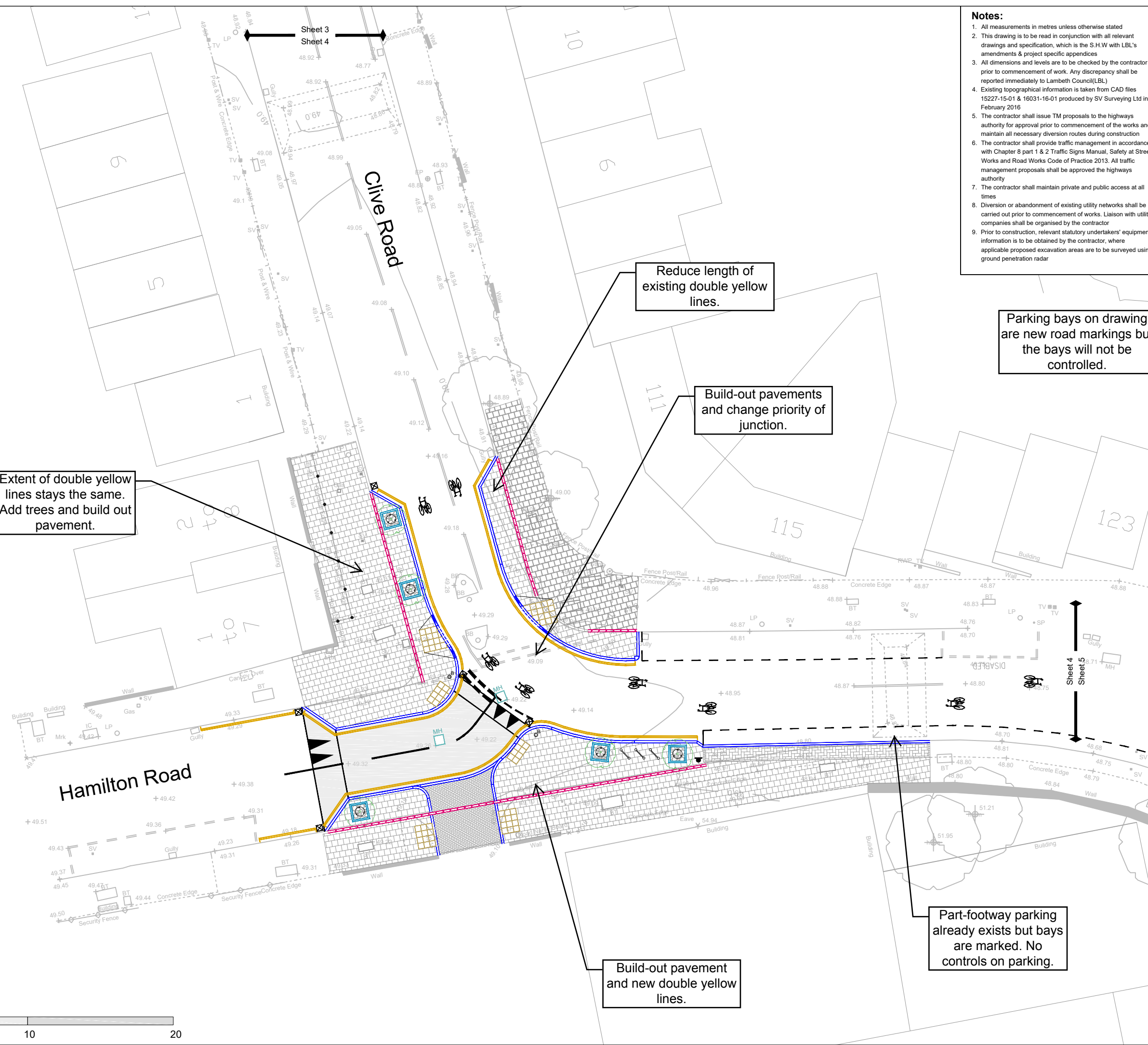

- Notes:**
1. All measurements in metres unless otherwise stated
  2. This drawing is to be read in conjunction with all relevant drawings and specification, which is the S.H.W with LBL's amendments & project specific appendices
  3. All dimensions and levels are to be checked by the contractor prior to commencement of work. Any discrepancy shall be reported immediately to Lambeth Council(LBL)
  4. Existing topographical information is taken from CAD files 15227-15-01 & 16031-16-01 produced by SV Surveying Ltd in February 2016
  5. The contractor shall issue TM proposals to the highways authority for approval prior to commencement of the works and maintain all necessary diversion routes during construction
  6. The contractor shall provide traffic management in accordance with Chapter 8 part 1 & 2 Traffic Signs Manual, Safety at Street Works and Road Works Code of Practice 2013. All traffic management proposals shall be approved the highways authority
  7. The contractor shall maintain private and public access at all times
  8. Diversion or abandonment of existing utility networks shall be carried out prior to commencement of works. Liaison with utility companies shall be organised by the contractor
  9. Prior to construction, relevant statutory undertakers' equipment information is to be obtained by the contractor, where applicable proposed excavation areas are to be surveyed using ground penetration radar

- Drawing Status:**  
These drawings have been produced with reference to the CDM Regulations 2015, Regulation 9.
- These Drawings are for planning approvals and are not to be used for construction purposes. It is the responsibility of the contractor and client to identify risks associated with the construction stage and to design appropriate measures to mitigate. The risks identified on the PJA Scheme Design Risk Assessment are based on the information available at the time of the design (drawing date) Where shown on PJA Design Drawings, the position of services is based on information provided by other parties at the time of the design and is for guidance only. It is the responsibility of the Client and Contractor to verify the exact position of any services before commencing works on site.
- Client Duties:**  
The Client is directed to Regulation 4 of the CDM 2015 Regulations: Client duties in relation to managing projects
- Raised table at flush kerb height, see relevant Kerbs, Footways & Paving drawing for details
  - Footway & cross-over block paving, see relevant Kerbs, Footways & Paving drawing for details
  - Natural coloured artificial stone paving, see relevant Kerbs, Footways & Paving drawing for details
  - Buff Blister tactile paving, see relevant Kerbs, Footways & Paving drawing for details
  - Granite kerb, see relevant Kerbs, Footways & Paving drawing for details
  - Dropped kerb, see relevant Kerbs, Footways & Paving drawing for details
  - Precast concrete channel, see relevant Kerbs, Footways & Paving drawing for details
  - Marshalls Keybloc (Natural), see relevant Kerbs, Footways & Paving drawing for details
  - White thermoplastic road marking, see relevant sign and line drawing for details
  - Primrose line marking, see relevant sign and line drawing for details
  - Top soil, see relevant Kerbs, Footways & Paving drawing for details
  - Existing service cover to be raised/lowered, see relevant Kerbs, Footways & Paving drawing for details
  - Carriageway gully / footway gully, see relevant Drainage drawing for details
  - Existing gully
  - Existing lamp column
  - Existing Tree
  - Supply & plant tree (tree species specified by borough arboriculturist) Tree guard as per standard drawing LoHAC 4000.10
  - Remove from store and re-erect 76mm Ø black sign post, ensure sign post is capped as per standard drawing LoHAC 1200.01 (Non-illuminated)
  - Supply & install Fumitubes Transport Bollard polyurethane (PU) TRL 900 with 2 yellow reflective bands as per standard drawing LoHAC 4000.01
  - Supply & install brass stud to manufacturer's specification

Rev / Date	Description	Drm	Chk'd

**PHIL JONES ASSOCIATES**  
transport planning consultants  
Unit 16 The Aquarium, 1-7 King Street, Reading, RG1 2AN  
Tel: 01189560909  
reading@philjonesassociates.co.uk  
www.philjonesassociates.co.uk

**Client**  
Sustrans

**Project**  
Quietway 07  
Lambeth - Detailed Design

**Drawing**  
Clive Road - Hamilton Road  
General Arrangement  
Sheet 04 of 11

**Drawn by:** JMQ<sub>28/09/2016</sub> **Scale:** 1:250 @ A3  
**Checked by:** SUS<sub>28/10/2016</sub> **Revision:** -

**Drawing No.** Q7-D-GA-16-00-01 **Revision** -

© Crown copyright and database rights 2015  
Ordnance Survey 100035971 / 0159

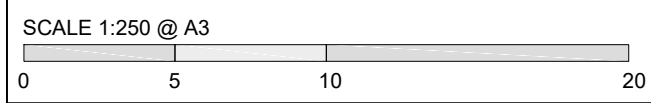

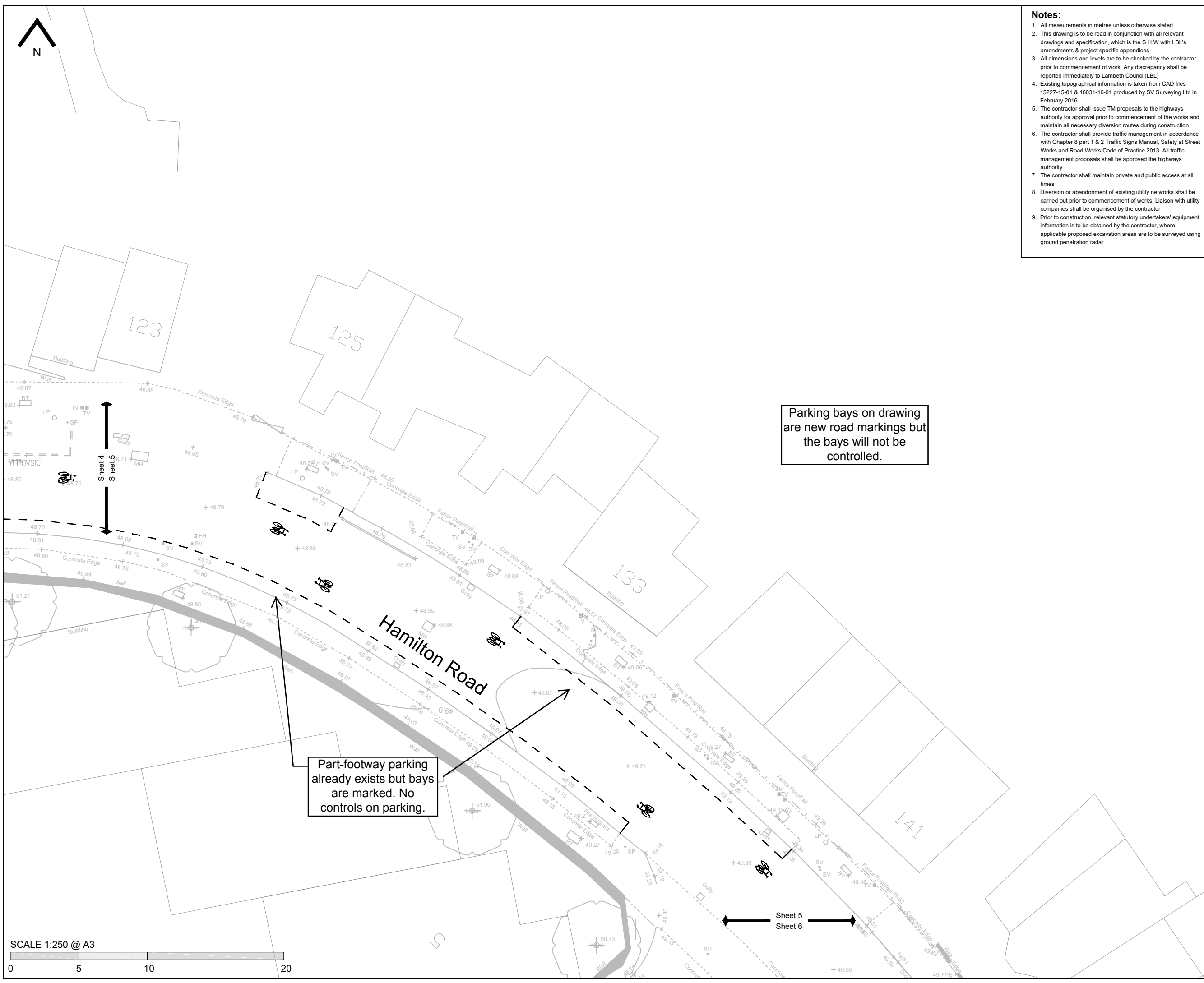

Parking bays on drawing are new road markings but the bays will not be controlled.

Part-footway parking already exists but bays are marked. No controls on parking.

**Notes:**

1. All measurements in metres unless otherwise stated
2. This drawing is to be read in conjunction with all relevant drawings and specification, which is the S.H.W with LBL's amendments & project specific appendices
3. All dimensions and levels are to be checked by the contractor prior to commencement of work. Any discrepancy shall be reported immediately to Lambeth Council(LBL)
4. Existing topographical information is taken from CAD files 15227-15-01 & 16031-16-01 produced by SV Surveying Ltd in February 2016
5. The contractor shall issue TM proposals to the highways authority for approval prior to commencement of the works and maintain all necessary diversion routes during construction
6. The contractor shall provide traffic management in accordance with Chapter 8 part 1 & 2 Traffic Signs Manual, Safety at Street Works and Road Works Code of Practice 2013. All traffic management proposals shall be approved the highways authority
7. The contractor shall maintain private and public access at all times
8. Diversion or abandonment of existing utility networks shall be carried out prior to commencement of works. Liaison with utility companies shall be organised by the contractor
9. Prior to construction, relevant statutory undertakers' equipment information is to be obtained by the contractor, where applicable proposed excavation areas are to be surveyed using ground penetration radar

**Drawing Status:**

These drawings have been produced with reference to the CDM Regulations 2015, Regulation 9.

These Drawings are for planning approvals and are not to be used for construction purposes. It is the responsibility of the contractor and client to identify risks associated with the construction stage and to design appropriate measures to mitigate. The risks identified on the PJA Scheme Design Risk Assessment are based on the information available at the time of the design (drawing date) Where shown on PJA Design Drawings, the position of services is based on information provided by other parties at the time of the design and is for guidance only. It is the responsibility of the Client and Contractor to verify the exact position of any services before commencing works on site.

**Client Duties:**

The Client is directed to Regulation 4 of the CDM 2015 Regulations: Client duties in relation to managing projects

- White thermoplastic road marking, see relevant sign and line drawing for details
- Primrose line marking, see relevant sign and line drawing for details

Rev / Date	Description	Drn	Chk'd
------------	-------------	-----	-------

**PHIL JONES ASSOCIATES**  
 transport planning consultants  
 Unit 16 The Aquarium, 1-7 King Street,  
 Reading, RG1 2AN  
 Tel: 01189560909  
 reading@philjonesassociates.co.uk  
 www.philjonesassociates.co.uk

**Client**  
 Sustrans

**Project**  
 Quietway 07  
 Lambeth - Detailed Design

**Drawing**  
 Hamilton Road  
 General Arrangement  
 Sheet 05 of 11

Drawn by: JMQ <sub>28/09/2016</sub>	Scale: 1:250 @ A3
Checked by: SUS <sub>28/10/2016</sub>	Revision: -
Drawing No. Q7-D-GA-16-00-02	

