

# HAVE YOUR SAY ON PROPOSED CHANGES TO CHERRY TREE FAMILY CENTRE

Lambeth Council would like your views on the design proposals to convert the former Cherry Tree nursery school building on Barston Road to form a Family Centre delivering a range of services for the London Borough of Lambeth.

The proposed design has evolved from early discussions with the stakeholders, recently commissioned building and site-wide surveys, assessment of the schedule of accommodation, the quality of the building materiality, site-wide circulation, and more detailed end user input.

Your thoughts and views will help us in shaping the spaces and detailed designs.

The consultation runs from 09 September 2022 to 09 October 2022.

Please share your views on the design proposals by completing the online survey or contacting us at [cherrytreeproject@lambeth.gov.uk](mailto:cherrytreeproject@lambeth.gov.uk)

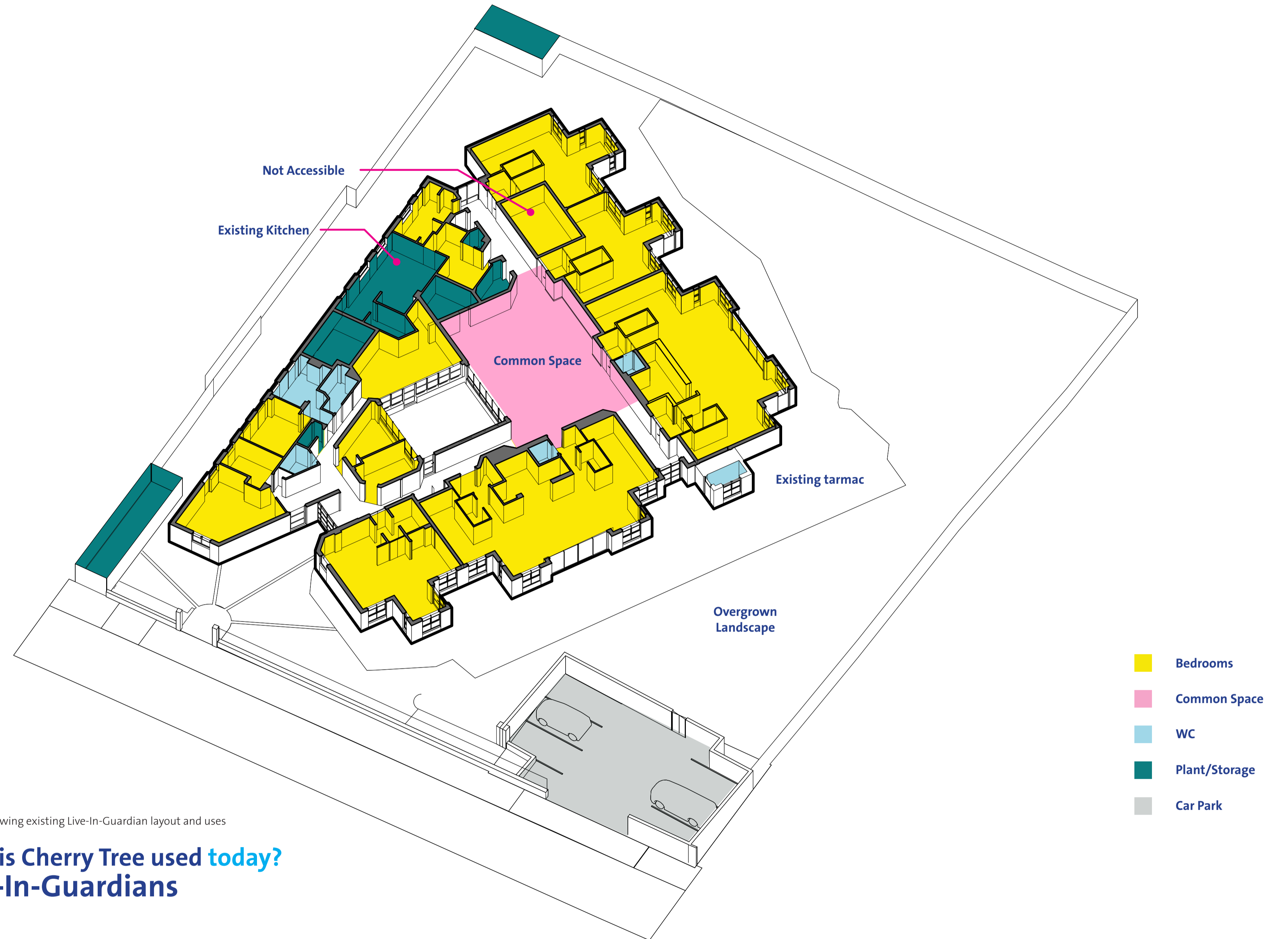

Street View of main entrance



Neglected entrance



Live-In-Guardian room/storage



Neglected outdoor area



# HAVE YOUR SAY ON PROPOSED CHANGES TO CHERRY TREE FAMILY CENTRE

## What are we proposing?

The proposal is to move the current family contact centre (14 White Hart St, London SE11 4EP) to the old Cherry Tree Nursery located at 8 Barston Rd, Norwood, London SE27 9HE. The old Cherry Tree Nursery will be re-designed to accommodate the proposed Cherry Tree Family Centre.

The single-storey building is no longer used as a nursery and is currently looked after by live-in guardians. This feasibility examines the potential to locate 2 services within the building, with flexibility to provide accommodation for supplementary services.



3D overlooking the entire site

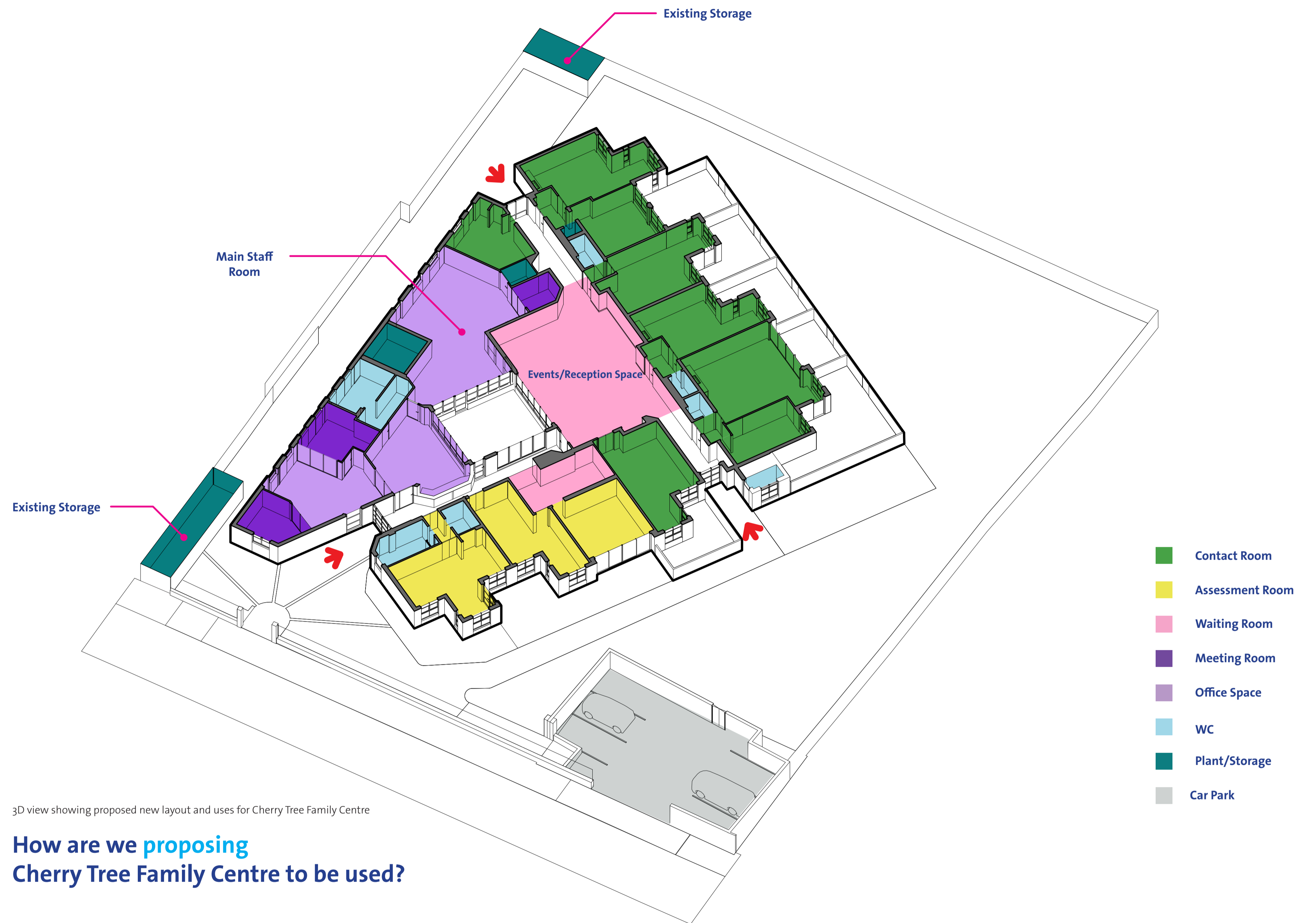

3D view showing proposed new layout and uses for Cherry Tree Family Centre

## How are we proposing Cherry Tree Family Centre to be used?



3D view showing reception at main entrance



3D view showing corridor leading to multi-use space & waiting room



3D view showing the multi-use & waiting room



3D view showing new main office space



# HAVE YOUR SAY ON PROPOSED CHANGES TO CHERRY TREE FAMILY CENTRE

## What are we proposing?

Key design elements:

- Creating a dedicated staff entrance
- Developing landscaping works to create secure, clear and accessible approaches to the public entrances.
- Removing the new build lobby/reception extension and instead opening up areas within the building to provide a welcoming entrance sequence for both services.
- Removing the redundant catering kitchen and providing domestic scale kitchens within three Contact Rooms.
- Improving daylight levels and views within circulation spaces.
- Increasing the provision of Accessible WCs.
- Improving facilities for Staff including a Staff Room and a dedicated WCs and showers.
- The integration of sustainable energy systems, such as an Air Source Heat Pump.
- Providing electric car charging points.



Proposed Ground Floor Plan with red annotation showing entrance points



Proposed site plan of overall scheme



Improved landscaping and access



New landscaping and access to contact room reception



New landscaping and access to contact room reception