

New Premises Licence

Premises Details

Premises Address *

67 WESTOW HILL LONDON LAMBETH SE19 1TS

Telephone number at premises (if any)

Non-domestic value of premises. *

£ [REDACTED]

Applicant Details

I/We apply for a premises licence under section 17 of the Licensing Act 2003 for the premises described in Part 1 below (the premises) and I/we are making this application to you as the relevant licensing authority in accordance with section 12 of the Licensing Act 2003.

Please state whether you are applying for a premises licence as:

a person other than an individual -as a limited company/
limited liability partnership

Applicant Details

If you are applying as a person described in one of the above please confirm: *

I am carrying on or proposing to carry on a business which involves the use of the premises for licensable activities; or

Other Applicant (Non Individual)

Name *

Sourcing Wines Ltd

Registered Address *

141-157 Acre Lane

Office 306

Town/City *

London

Other Applicant (Non Individual)

County	
Postcode *	SW2 5UA
Registered Number (where applicable)	13640597
Description of applicant (for example partnership, company, unincorporated association, etc) *	Limited Company
Telephone Number	██████████
Email *	████████████████████

Operating Schedule

When do you want the premises licence to start? *	18/01/2023
If you wish the licence to be valid only for a limited period, when do you want it to end?	
Please give a general description of the premises. *	Wine shop and bar, selling alcohol for consumption on and off premises with the the provision of cold food. The wine bar will also include a section of outdoor seating as highlighted on the provided plan. Alcohol sold for consumption off premises will only be sold in sealed containers (such as unopened wine bottles). A dispersal policy will be provided and adhered to with the aim to minimise disruption.
If 5,000 or more people are expected to attend the premises at any one time, please state the number expected to attend.	

Operating Schedule

What licensable activities do you intend to carry on from the premises? * (Please see sections 1 and 14 of the Licensing Act 2003 and Schedules 1 and 2 to the Licensing Act 2003)

Provision of regulated entertainment (please read guidance note 2) *

 Plays

 Films

Operating Schedule

- Indoor Sporting Events
- Boxing or Wrestling
- Live Music
- Recorded Music
- Performances of Dance
- Anything of a similar description falling under Music or Dance
- Provision of late night refreshment
- Supply of Alcohol

Supply of Alcohol Standard Times

Standard days and timings, where you intend to use the premises for the supply of alcohol. (please read guidance note 7)*
Please enter times in 24hr format (HH:MM)

Day *	Week Days
	10:00
	23:00

Supply of Alcohol Standard Times

Standard days and timings, where you intend to use the premises for the supply of alcohol. (please read guidance note 7)*
Please enter times in 24hr format (HH:MM)

Day *	Saturday
	10:00

Supply of Alcohol Standard Times

Supply of Alcohol Standard Times

Standard days and timings, where you intend to use the premises for the supply of alcohol. (please read guidance note 7)*
Please enter times in 24hr format (HH:MM)

Day *

Supply of Alcohol

Will the supply of alcohol be for consumption on premises or off premises or both? (please read guidance note 8) *

State any seasonal variations for the supply of alcohol. (please read guidance note 5)

Please state any non-standard timings, where you intend to use the premises for the supply of alcohol at different times from the Standard days and times listed?(please read guidance note 6)

Designated Premises Supervisor

State the name and details of the individual whom you wish to specify on the licence as designated premises supervisor (Please see declaration about the entitlement to work in the checklist at the end of the form)

Title *

First name *

Surname *

Street address *

Designated Premises Supervisor

Town/City *

County

Postcode *

Personal Licence Number (if known)

Issuing Licensing Authority (if known)

Adult Entertainment

Please highlight any adult entertainment or services, activities, other entertainment or matters ancillary to the use of the premises that may give rise to concern in respect of children (please read guidance note 9).

None

Opening Hours Standard Times

Standard days and timings, where the premises are open to the public. (please read guidance note 7) * Please enter times in 24hr format (HH:MM)

Day *

Week Days

10:00

23:00

Opening Hours Standard Times

Standard days and timings, where the premises are open to the public. (please read guidance note 7) * Please enter times in 24hr format (HH:MM)

Day *

Saturday

10:00

23:00

Opening Hours Standard Times

Standard days and timings, where the premises are open to the public. (please read guidance note 7) * Please enter times in 24hr format (HH:MM)

Day *

Sunday

11:00

20:00

Licensing Objectives

Describe any additional steps you intend to take to promote the four licensing objectives as a result of the proposed variation:

a) General - all four licensing objectives (b, c, d and e) (please read guidance note 10)

b) The prevention of crime and disorder

c) Public safety

d) The prevention of public nuisance

e) The protection of children from harm

24hr CCTV will be enforced at the premises, with long term cloud storage of all footage being readily available to the authorities if ever needed. The premises will always be sufficiently staffed to discourage theft and disorder. Full internal shuttering is fitted to premises, which will be always shut during closed hours. Names, descriptions and/or photography of customers previously refused service will be kept on the premise and shared with other related local establishments.

All required fire safety signage and equipment will be present as per the recommendations of a full fire risk assessment. An incident book will be kept and maintained at the premise at all times. There shall be a limit of 40 people excluding staff in the premise at any one time to avoid overcrowding and as to not hinder evacuation procedures if/when required.

A dispersal policy will be enforced to ensure customers leave in a quiet and orderly fashion (attached to application). A strict Challenge 25 policy will be in place and a record of refusals kept on the premises at all times. All staff will be sufficiently trained to ensure these standards are maintained. Any customer who is deemed to be or at risk of becoming a nuisance, will be refused service.

A strict Challenge 25 policy will be in place and a record of refusals kept on the premises at all times. All staff will be sufficiently trained to ensure these standards are maintained.

Declarations

Declaration Type *

Sole Applicant - Individual or Other

Declarations

I have uploaded a copy of the plan of the premises. I have uploaded a copy of the consent form completed by the individual I wish to be designated premises supervisor, if applicable. I understand I must now advertise my application. I understand that if I do not comply with the above requirements my application will be rejected. Applicable to all individual applicants, including those in partnership which is not a limited liability partnership, but not companies or limited liability partnerships I have included documents demonstrating my entitlement to work in the United Kingdom (please read note 15)

IT IS AN OFFENCE, UNDER SECTION 158 OF THE LICENSING ACT 2003, TO MAKE A FALSE STATEMENT IN OR IN CONNECTION WITH THIS APPLICATION. THOSE WHO MAKE A FALSE STATEMENT MAY BE LIABLE ON SUMMARY CONVICTION TO A FINE OF ANY AMOUNT 'IT IS AN OFFENCE UNDER SECTION 24B OF THE IMMIGRATION ACT 1971 FOR A PERSON TO WORK WHEN THEY KNOW, OR HAVE REASONABLE CAUSE TO BELIEVE, THAT THEY ARE DISQUALIFIED FROM DOING SO BY REASON OF THEIR IMMIGRATION STATUS. THOSE WHO EMPLOY AN ADULT WITHOUT LEAVE OR WHO IS SUBJECT TO CONDITIONS AS TO EMPLOYMENT WILL BE LIABLE TO A CIVIL PENALTY UNDER SECTION 15 OF THE IMMIGRATION, ASYLUM AND NATIONALITY ACT 2006 AND PURSUANT TO SECTION 21 OF THE SAME ACT, WILL BE COMMITTING AN OFFENCE WHERE THEY DO SO IN THE KNOWLEDGE, OR WITH REASONABLE CAUSE TO BELIEVE, THAT THE EMPLOYEE IS DISQUALIFIED.

Signature/Declaration of applicant or applicant's solicitor or other duly authorised agent (see Guidance Note 11 & 12). If signing/applying on behalf of the applicant, please state your name and in what capacity you are authorised to sign/apply. When submitting an on-line application form the 'Declaration made' checkbox must be selected.

I understand I am not entitled to be issued with a licence if I do not have the entitlement to live and work in the UK (or if I am subject to a condition preventing me from doing work relating to the carrying on of a licensable activity) and that my licence will become invalid if I cease to be entitled to live and work in the UK (please read guidance note 15).

The DPS named in this application form is entitled to work in the UK (and is not subject to conditions preventing him or her from doing work relating to a licensable activity) and I have seen a copy of his or her proof of entitlement to work, if appropriate (please see note 15).

Full Name *

William Peter Burgess

Date *

18/01/2023

Capacity *

Applicant

Declaration made

Do you wish to provide alternative correspondence details? *

No

Email confirmation

On submission an email confirmation will be sent using the details below

Forename

Will

Surname /Company Name

Sourcing Wines Ltd

Email confirmation

Email *

Telephone

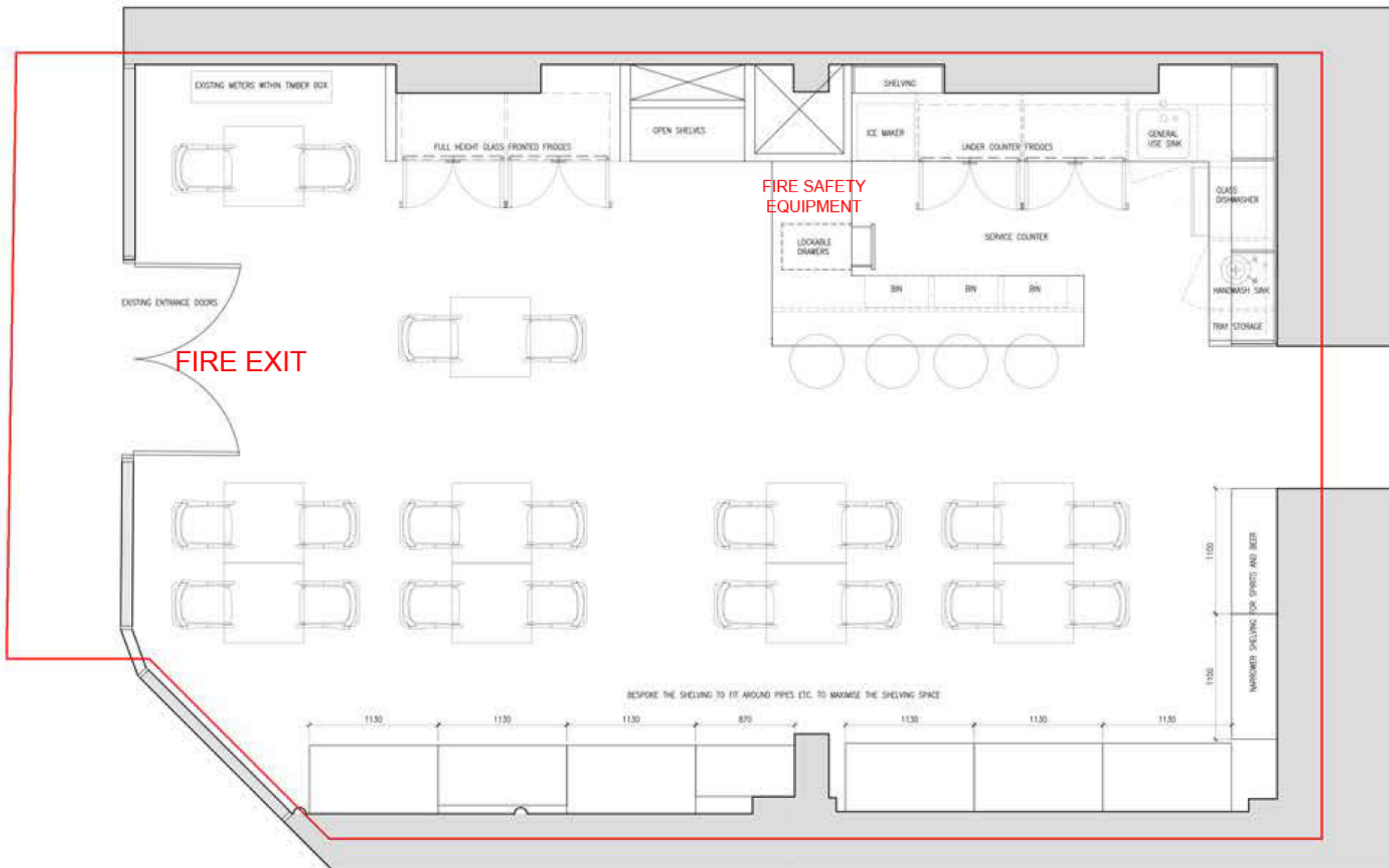

SCOPE OF WORKS:

DRAWINGS ARE BASED ON CHECK DIMS ONLY AND ALL MEASUREMENTS MUST BE VERIFIED ON SITE.

EXISTING TIMBER FLOOR TO BE RETAINED AND PROTECTED AS REQUIRED THROUGH THE BUILD. ALLOWANCE TO MAKE GOOD WHERE STRIP OUT LEAVES ANY DAMAGE.

EXISTING TIMBER WALL CLADDING TO BE REMOVED, WALL BEHIND TO BE MADE GOOD, REPLASTERED.

EXISTING COUNTER, ASSOCIATED FITTINGS TO BE REMOVED AND DISPOSED OF.

UNLESS OTHERWISE STATED ALL WALLS TO BE REPAINTED.

EXISTING CABLE TRAYS MAY REQUIRE TO BE RELOCATED TO SUIT THE NEW LIGHTING LAYOUT.

SHOP FRONT TO BE REPAINTED, NEW SIGNAGE. SPEC TBC.

NEW PLASTERBOARD WALLS, APPROX. 2300MM HIGH TO FORM ENCLOSURE TO FRIGDES, TO PROVIDE RECESSED OPEN SHELVING. TILED FINISH.

NEW SHOP COUNTER WITH UNDER COUNTER AMENITIES INCLUDING DISHWASHER AND FRIGDES, WASH SINK AND HANDWASH BASIN. SOLID WORKTOP WITH SHELVING AS SHOWN ABOVE. MIRRORED FINISH BEHIND ALL COUNTER SHELVING. TILED FRONT TO COUNTER.

NEW DISPLAY SHELVING, APPROX. 2300MM HIGH TO SHOP PERIMETER. METAL FRAMEWORK, TIMBER SHELVES. CONTRACTOR PROPOSALS FOR SHELVING WHERE ABUTTING PIPEWORK ETC. TO ENSURE FLUSH FRONTS ALONG ALL DISPLAY SHELVING.

NEW LIGHTING TO SHOP TO INCLUDE TRACK LIGHTING TO ALL WINE DISPLAY AND PENDANTS TO COUNTER AND TABLES - SPEC TBC.

WORKS TO BACK OF HOUSE ARE YET TO BE AGREED BUT LIKELY TO BE LIGHT TOUCH REFRESH ONLY. KITCHEN AREA IS UNSEEN AND WILL REQUIRE FURTHER INVESTIGATION.

SECURITY SCOPE TBC - LOCK CHANGES, SHUTTERS ASSUMED OPERATIONAL BUT TO BE VERIFIED.

DO NOT SCALE ANY DIMENSIONS OFF THIS DRAWING. ANY DISCREPANCIES BETWEEN THIS DRAWING AND OTHER INFORMATION ARE TO BE REFERRED TO THE DRAWING. WHERE THE DRAWING REFERS TO AN EXISTING BUILDING OR CLAMPED CONSTRUCTION THE CONTRACTOR IS RESPONSIBLE FOR CHECKING THAT THERE IS NO CONFLICT BETWEEN ACTUAL BUILDING DIMENSIONS AND DRAWING DIMENSIONS. IN THE EVENT OF DISCREPANCIES BETWEEN THE DRAWING AND DIMENSIONS OFFERED BY THE CONTRACTOR FOR RELEVANT BUILDING COMPONENTS, THE CONTRACTOR'S DIMENSIONS SHALL TAKE PRECEDENCE. ANY CONFLICTS ARISING OUT OF INFORMATION AS NOTED ABOVE MUST BE REPORTED IMMEDIATELY TO THE DESIGNER. THIS DRAWING IS THE PROPERTY OF SHAW STUBBS. ALL DIMENSIONS ARE IN MILLIMETRES UNLESS OTHERWISE STATED.

client	THE SOURCING TABLE
	WESTOW HILL CRYSTAL PALACE
project	SHOP RENOVATION
	CRYSTAL PALACE LONDON

drawing title	GROUND FLOOR GENERAL ARRANGEMENT PLAN		
date	10.01.23	scale	1:50@A3
		des.	SH
		rev.	-

ISSUED FOR INFORMATION	
------------------------	--