

A key outcome of the HLF's investment would be that heritage is in a better condition.

St. Stephen's Chapel is currently on Historic England's Heritage at Risk (HAR) register. Proposals include work to conserve and repair the Chapel and bring it back into use, including facilities to aid accessibility. It would be made available as a flexible space for events, functions, installations and exhibitions.

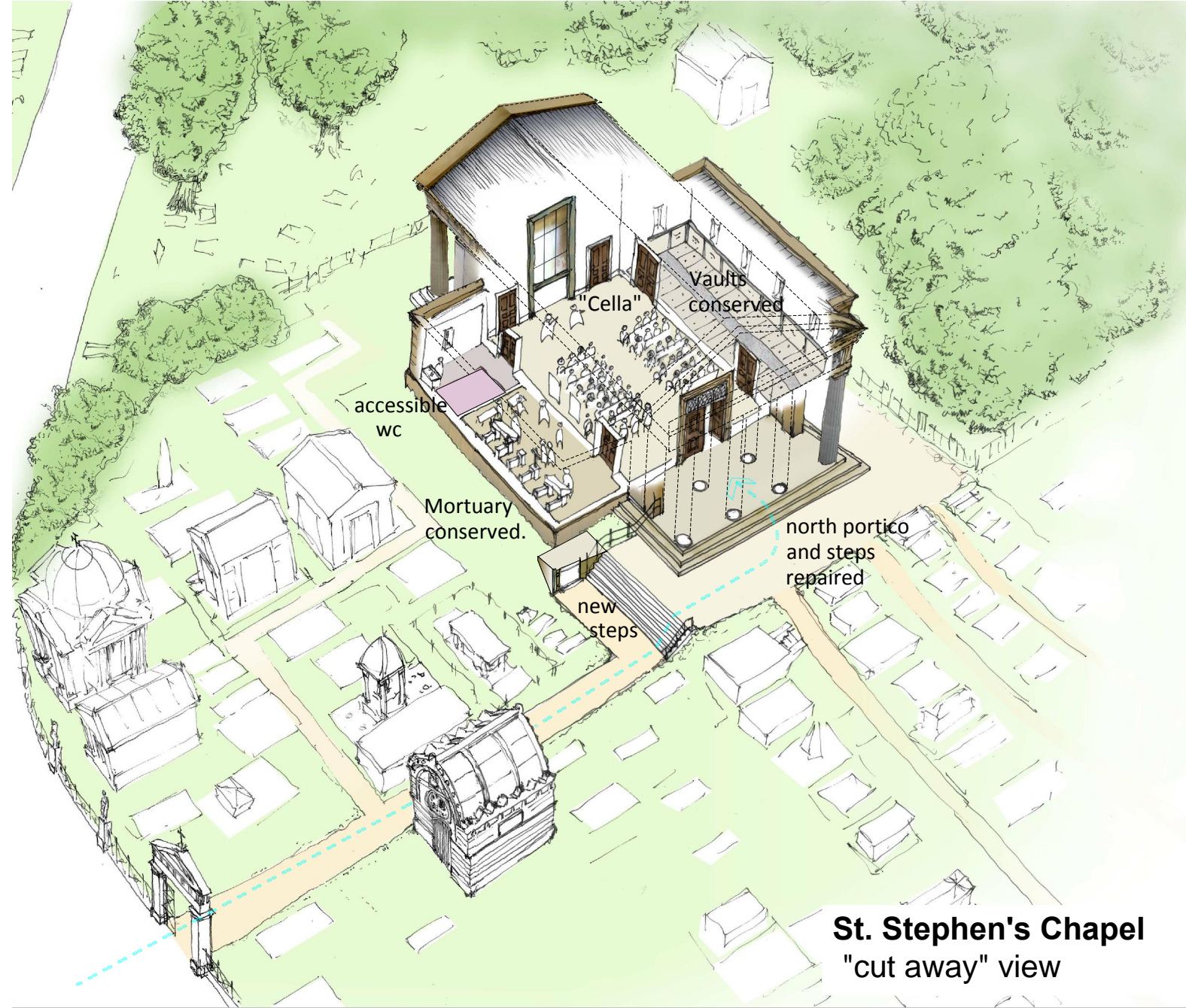

16 significant Listed monuments in the cemetery are currently on the Heritage at Risk register. Our bid includes a commitment to conserve these monuments in order to remove them from the register. In addition to conservation of these, and other monuments, there will be more opportunities to learn about them, and those they commemorate.

