

Application to vary a premises licence under the Licensing Act 2003

PLEASE READ THE FOLLOWING INSTRUCTIONS FIRST

Before completing this form please read the guidance notes at the end of the form. If you are completing this form by hand please write legibly in block capitals. In all cases ensure that your answers are inside the boxes and written in black ink. Use additional sheets if necessary. You may wish to keep a copy of the completed form for your records.

I/We Phillip Oppenheim pp Cubana Waterloo ltd
(Insert name(s) of applicant)

being the premises licence holder, apply to vary a premises licence under section 34 of the Licensing Act 2003 for the premises described in Part 1 below.

Premises licence number	12/00693/PRMTRN/290
--------------------------------	---------------------

Part 1 – Premises Details

Postal address of premises or, if none, ordnance survey map reference or description			
Cubana 48 Lower Marsh			
Post town	London	Post code	SE17RG

Telephone number at premises (if any)	[REDACTED]
Non-domestic rateable value of premises	£ 42,146

Part 2 – Applicant Details

Daytime contact telephone number	[REDACTED]		
Email address (optional)	[REDACTED]		
Current postal address if different from premises address			
Post town		Post code	

Part 3 – Variation

Do you want the proposed variation to have effect as soon as possible?

Please tick ✓ yes
x

If not do you want the variation to take effect from

Day	Month	Year
<input type="text"/>	<input type="text"/>	<input type="text"/>

Please describe briefly the nature of the proposed variation (Please see guidance note1)

Cubana has had a license at the premises since 1998. Cubana is a bar-restaurant and we serve a large amount of freshly-prepared food, made with free-range produce, as well as drinks. Our main drinks offer is cocktails, prepared with fresh tropical fruits and juices

The variation is to extend the licence to cover a flat rooftop area above part of the current premises. The area in question extends from the flat roof into a former flat; and planning consent has been granted for the area, comprising approx. 60 sq metres. The area in question is bounded on two sides by a further two stories of the remainder of the building which are used by Cubana for staff accommodation, so that the proposed roof terrace overlooks public roads and space

The proposed roof terrace will have glass balustrades and a retractable canopy which will be able to be secured to the balustrades with side panels depending on weather

The variation is to allow the serving and consumption of food and drink between 1200 and 2300 daily. The area will be covered by a retractable canopy and side sections with a limit of 70 people

If your proposed variation would mean that 5,000 or more people are expected to attend the premises at any one time, please state the number expected to attend.

Part 4 – Operating Schedule

Please complete those parts of the Operating Schedule below which would be subject to change if this application to vary is successful.

Provision of regulated entertainment

Please tick ✓ yes

- a) plays (if ticking yes, fill in box A)
- b) films (if ticking yes, fill in box B)
- c) indoor sporting events (if ticking yes, fill in box C)
- d) boxing or wrestling entertainment (if ticking yes, fill in box D)
- e) live music (if ticking yes, fill in box E)
- f) recorded music (if ticking yes, fill in box F)
- g) performances of dance (if ticking yes, fill in box G)
- h) anything of a similar description to that falling within (e), (f) or (g) (if ticking yes, fill in box H)

Provision of late night refreshment (if ticking yes, fill in box I)

Sale by retail of alcohol (if ticking yes, fill in box J)

On premises only

In all cases complete boxes K, L and M

A

Plays Standard days and timings <i>(please read guidance note 6)</i>			Will the performance of a play take place indoors or outdoors or both – please tick ✓ <i>(please read guidance note 2)</i>	Indoors	<input type="checkbox"/>
				Outdoors	<input type="checkbox"/>
				Both	<input type="checkbox"/>
Day	Start	Finish	Please give further details here <i>(please read guidance note 3)</i>		
Mon					
Tue			State any seasonal variations for performing plays <i>(please read guidance note 4)</i>		
Wed					
Thur			Non standard timings. Where you intend to use the premises for the performance of plays at different times to those listed in the column on the left, please list <i>(please read guidance note 5)</i>		
Fri					
Sat					
Sun					

B

Films Standard days and timings <i>(please read guidance note 6)</i>			Will the exhibition of films take place indoors or outdoors or both – please tick ✓ <i>(please read guidance note 2)</i>	Indoors	<input type="checkbox"/>
				Outdoors	<input type="checkbox"/>
				Both	<input type="checkbox"/>
Day	Start	Finish	Please give further details here <i>(please read guidance note 3)</i>		
Mon					
Tue			State any seasonal variations for the exhibition of films <i>(please read guidance note 4)</i>		
Wed					
Thur			Non standard timings. Where you intend to use the premises for the exhibition of films at different times to those listed in the column on the left, please list <i>(please read guidance note 5)</i>		
Fri					
Sat					
Sun					

C

Indoor sporting events Standard days and timings <i>(please read guidance note 6)</i>			Please give further details <i>(please read guidance note 3)</i>
Day	Start	Finish	
Mon			State any seasonal variations for indoor sporting events <i>(please read guidance note 4)</i>
Tue			
Wed			
Thur			Non standard timings. Where you intend to use the premises for indoor sporting events at different times to those listed in the column on the left, please list <i>(please read guidance note 5)</i>
Fri			
Sat			
Sun			

D

Boxing or wrestling entertainments Standard days and timings <i>(please read guidance note 6)</i>			Will the boxing or wrestling entertainment take place indoors or outdoors or both – please tick ✓ <i>(please read guidance note 2)</i>	
Day	Start	Finish	Indoors	<input type="checkbox"/>
Mon			Outdoors	<input type="checkbox"/>
Tue			Both	<input type="checkbox"/>
Wed			Please give further details here <i>(please read guidance note 3)</i>	
Thur			State any seasonal variations for boxing or wrestling entertainment <i>(please read guidance note 4)</i>	
Fri			Non standard timings. Where you intend to use the premises for boxing or wrestling entertainment at different times to those listed in the column on the left, please list <i>(please read guidance note 5)</i>	
Sat				
Sun				

E

Live music Standard days and timings <i>(please read guidance note 6)</i>			Will the performance of live music take place indoors or outdoors or both – please tick ✓ <i>(please read guidance note 2)</i>	Indoors	<input type="checkbox"/>			
				Outdoors	<input type="checkbox"/>			
				Both	<input type="checkbox"/>			
Day	Start	Finish	Please give further details here <i>(please read guidance note 3)</i>					
Mon								
Tue								
Wed						State any seasonal variations for the performance of live music <i>(please read guidance note 4)</i>		
Thur								
Fri						Non standard timings. Where you intend to use the premises for the performance of live music at different times to those listed in the column on the left, please list <i>(please read guidance note 5)</i>		
Sat								
Sun								

F

Recorded music Standard days and timings <i>(please read guidance note 6)</i>			Will the playing of recorded music take place indoors or outdoors or both – please tick ✓ <i>(please read guidance note 2)</i>	Indoors	<input type="checkbox"/>
				Outdoors	<input type="checkbox"/>
				Both	<input checked="" type="checkbox"/>
Day	Start	Finish	Please give further details here <i>(please read guidance note 3)</i> The playing of recorded music for background only at moderate volume between– the rooftop terrace area is bounded on two sides by flats occupied by Cubana and on the other two sides there is a considerable distance to any dwellings or offices		
Mon	0900	2200			
Tue	0900	2200	State any seasonal variations for the playing of recorded music <i>(please read guidance note 4)</i>		
Wed	0900	2200			
Thur	0900	2200	Non standard timings. Where you intend to use the premises for the playing of recorded music at different times to those listed in the column on the left, please list <i>(please read guidance note 5)</i>		
Fri	9000	2200			
Sat	1200	2200			
Sun	1200	2200			

G

Performances of dance Standard days and timings <i>(please read guidance note 6)</i>			Will the performance of dance take place indoors or outdoors or both – please tick ✓ <i>(please read guidance note 2)</i>	Indoors	<input type="checkbox"/>
				Outdoors	<input type="checkbox"/>
				Both	<input type="checkbox"/>
Day	Start	Finish	Please give further details here <i>(please read guidance note 3)</i>		
Mon					
Tue			State any seasonal variations for the performance of dance <i>(please read guidance note 4)</i>		
Wed					
Thur			Non standard timings. Where you intend to use the premises for the performance of dance at different times to those listed in the column on the left, please list <i>(please read guidance note 5)</i>		
Fri					
Sat					
Sun					

H

Anything of a similar description to that falling within e, f or g Standard days and timings <i>(please read guidance note 6)</i>			Please give a description of the type of entertainment you will be providing		
Day	Start	Finish	Will this entertainment take place indoors or outdoors or both – please tick ✓ <i>(please read guidance note 2)</i>	Indoors	<input type="checkbox"/>
Mon				Outdoors	<input type="checkbox"/>
Tue				Both	<input type="checkbox"/>
Tue			Please give further details here <i>(please read guidance note 3)</i>		
Wed			State any seasonal variations for entertainment of a similar description to that falling within (e), (f) or (g) <i>(please read guidance note 4)</i>		
Thur					
Fri			Non standard timings. Where you intend to use the premises for the entertainment of a similar description to that falling within (e), (f) or (g) at different times to those listed in the column on the left, please list <i>(please read guidance note 5)</i>		
Sat					
Sun					

Late night refreshment Standard days and timings <i>(please read guidance note 6)</i>			Will the provision of late night refreshment take place indoors or outdoors or both – please tick ✓ (please read guidance note 2)	Indoors	<input type="checkbox"/>
				Outdoors	<input type="checkbox"/>
				Both	<input type="checkbox"/>
Day	Start	Finish	Please give further details here (please read guidance note 3)		
Mon					
Tue					
Wed			State any seasonal variations for the provision of late night refreshment (please read guidance note 4)		
Thur					
Fri			Non standard timings. Where you intend to use the premises for the provision of late night refreshment at different times, to those listed in the column on the left, please list (please read guidance note 5)		
Sat					
Sun					

J

Supply of alcohol Standard days and timings <i>(please read guidance note 6)</i>			Will the supply of alcohol be for consumption: (Please tick box ✓) (please read guidance note 7)	On the premises	x <input type="checkbox"/>
				Off the premises	<input type="checkbox"/>
				Both	<input type="checkbox"/>
Day	Start	Finish	State any seasonal variations for the supply of alcohol (please read guidance note 4)		
Mon	1200	2300			
Tue	1200	2300			
Wed	1200	2300	Non standard timings. Where you intend to use the premises for the supply of alcohol at different times to those listed in the column on the left, please list (please read guidance note 5)		
Thur	1200	2300			
Fri	1200	2300			
Sat	1200	2300			
Sun	1200	2300			

K

Please highlight any adult entertainment or services, activities, other entertainment or matters ancillary to the use of the premises that may give rise to concern in respect of children *(please read guidance note 8)*

L

<p>Hours premises are open to the public Standard days and timings <i>(please read guidance note 6)</i></p>	<p>State any seasonal variations <i>(please read guidance note 4)</i></p>																								
<table border="1" style="width: 100%; border-collapse: collapse;"> <thead> <tr> <th style="width: 15%;">Day</th> <th style="width: 20%;">Start</th> <th style="width: 20%;">Finish</th> </tr> </thead> <tbody> <tr> <td>Mon</td> <td>0900</td> <td>2300</td> </tr> <tr> <td>Tue</td> <td>0900</td> <td>2300</td> </tr> <tr> <td>Wed</td> <td>0900</td> <td>2300</td> </tr> <tr> <td>Thur</td> <td>0900</td> <td>2300</td> </tr> <tr> <td>Fri</td> <td>0900</td> <td>2300</td> </tr> <tr> <td>Sat</td> <td>0900</td> <td>2300</td> </tr> <tr> <td>Sun</td> <td>0900</td> <td>2300</td> </tr> </tbody> </table>	Day	Start	Finish	Mon	0900	2300	Tue	0900	2300	Wed	0900	2300	Thur	0900	2300	Fri	0900	2300	Sat	0900	2300	Sun	0900	2300	<p>Non standard timings. Where you intend the premises to be open to the public at different times from those listed in the column on the left, please list <i>(please read guidance note 5)</i></p>
Day	Start	Finish																							
Mon	0900	2300																							
Tue	0900	2300																							
Wed	0900	2300																							
Thur	0900	2300																							
Fri	0900	2300																							
Sat	0900	2300																							
Sun	0900	2300																							

Please identify those conditions currently imposed on the licence which you believe could be removed as a consequence of the proposed variation you are seeking

--

Please tick ✓ yes

I have enclosed the premises licence

x

I have enclosed the relevant part of the premises licence

If you have not ticked one of these boxes please fill in reasons for not including the licence, or part of it, below

Reasons why I have failed to enclose the premises licence or relevant part of premises licence

--

M Describe any additional steps you intend to take to promote the four licensing objectives as a result of the proposed variation:

a) General – all four licensing objectives (b,c,d,e) (please read guidance note 9)

We do not believe that the proposed variation requires any further steps to promote the four licensing objectives as the proposed closing time for the roof terrace is 11.00pm; Cubana does have robust policies in place to cover the four objectives where relevant for the serving of alcohol during these hours; and further policies in place for later opening within the main bar-restaurant area where later opening is permitted

b) The prevention of crime and disorder

c) Public safety

d) The prevention of public nuisance

e) The protection of children from harm

Please tick ✓ yes

- I have made or enclosed payment of the fee x
- I have sent copies of this application and the plan to responsible authorities and others where applicable x
- I understand that I must now advertise my application x
- I have enclosed the premises licence or relevant part of it or explanation x
- I understand that if I do not comply with the above requirements my application will be rejected x

IT IS AN OFFENCE, LIABLE ON CONVICTION TO A FINE UP TO LEVEL 5 ON THE STANDARD SCALE, UNDER SECTION 158 OF THE LICENSING ACT 2003 TO MAKE A FALSE STATEMENT IN OR IN CONNECTION WITH THIS APPLICATION

Part 5 – Signatures (please read guidance note 10)

Signature of applicant (the current premises licence holder) or applicant’s solicitor or other duly authorised agent (please read guidance note 11). If signing on behalf of the applicant please state in what capacity.

Signature	
Date	
Capacity	

Where the premises licence is jointly held signature of 2nd applicant (the current premises licence holder) or 2nd applicant’s solicitor or other authorised agent (please read guidance note 12). If signing on behalf of the applicant please state in what capacity.

Signature	
Date	
Capacity	

Contact name (where not previously given) and address for correspondence associated with this application. (please read guidance note 13)

--

Telephone number (if any)

--

If you would prefer us to correspond with you by email your email address (optional)

phillip@cubana.co.uk preferred contact – thanks -

GROUND FLOOR PLAN

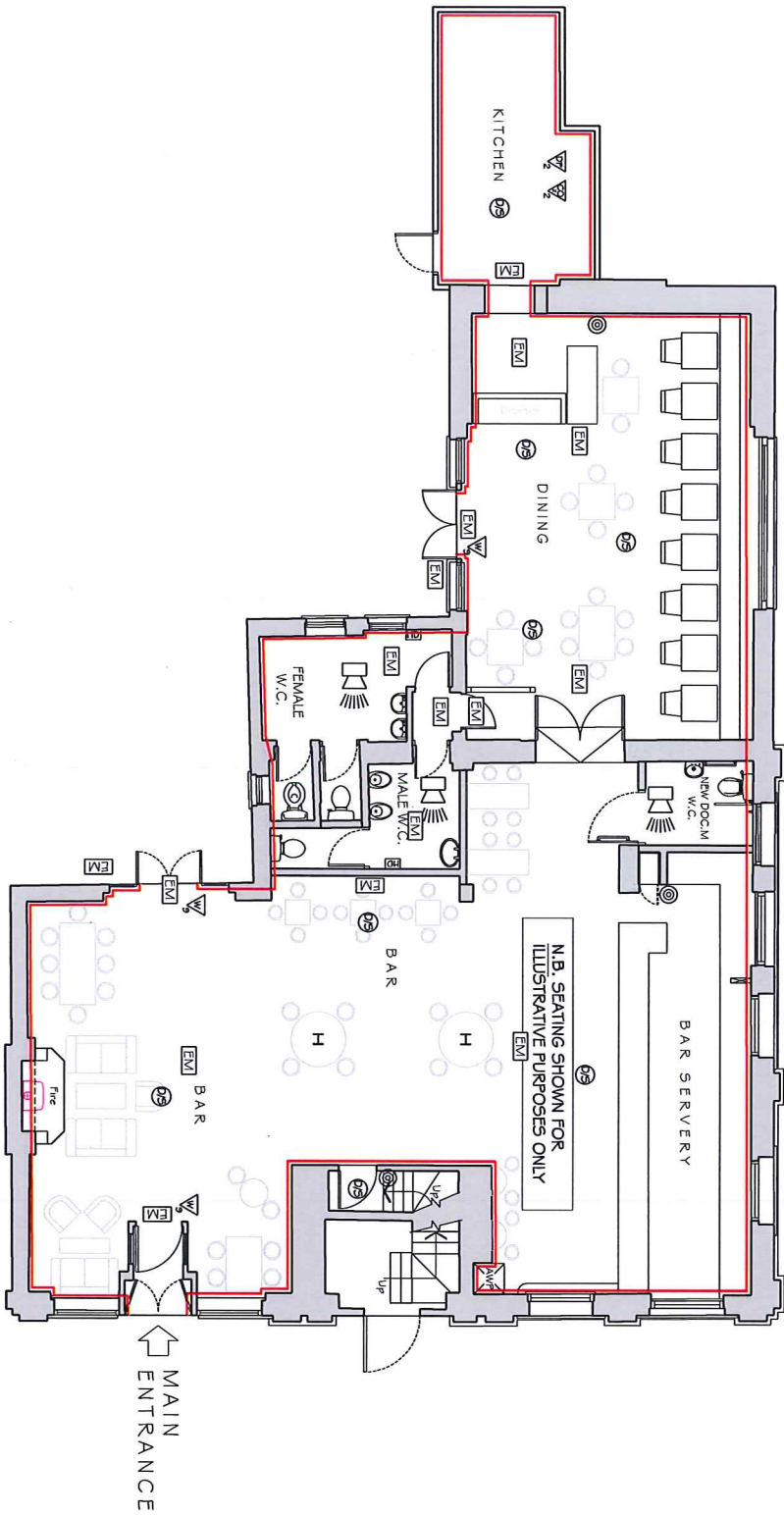

LEGEND

- 1 WATER EXTINGUISHER
- 2 CARBON DIOXIDE EXTINGUISHER
- 3 DRY POWDER EXTINGUISHER
- FIRE DETECTOR
- CALL POINT
- SOUNDER BEACON
- EMERGENCY LIGHT

RED LINE DESIGNATES AREA TO BE USED FOR LICENSEABLE ACTIVITIES / CONSUMPTION
 NOTE: THE POSITION OF FIRE SAFETY EQUIPMENT AS SHOWN ON THE PLAN, OR SUCH OTHER POSITION AS ASSIGNED FROM TIME TO TIME IN CONFORMANCE WITH THE AUTHORITIES.

GREENLINE DESIGN LTD.

Design Consultants

110 High Street, Hampton in Arden, Solihull, B90 4AD
 Tel: 0755 319290

Client: CITTIGLEN PUB COMPANY LTD.

Project: THE GREAT SOUTHERN, SE 19 10H

Drawing: LICENSING PLAN, INTERNAL

Scale: 1:50 @ A1
 1:100 @ A3

Project: F 1452
 Date: 05/10
 Dwg No: L 01

This Drawing is the property of GREENLINE DESIGN LTD. Copyright is reserved by GREENLINE DESIGN LTD. No part of this drawing may be reproduced, stored in a retrieval system or transmitted in any form or by any means, electronic, mechanical, photocopying, recording or otherwise, without the prior written consent of GREENLINE DESIGN LTD. ALL DIMENSIONS TO BE CHECKED ON SITE prior to the commencement of work. Any discrepancies to be reported to the Supervising Officer.

MOUNTBATTEN CLOSE

GYPSY HILL TAVERN P.H.

**PREMISES
BOUNDARY**

NOTE: THE POSITION OF THE SAFETY EQUIPMENT AS SHOWN ON THE PLAN, IS SUBJECT TO THE POSITION AS ASSESSED FROM TIME TO TIME IN CONSULTATION WITH THE AUTHORITIES.

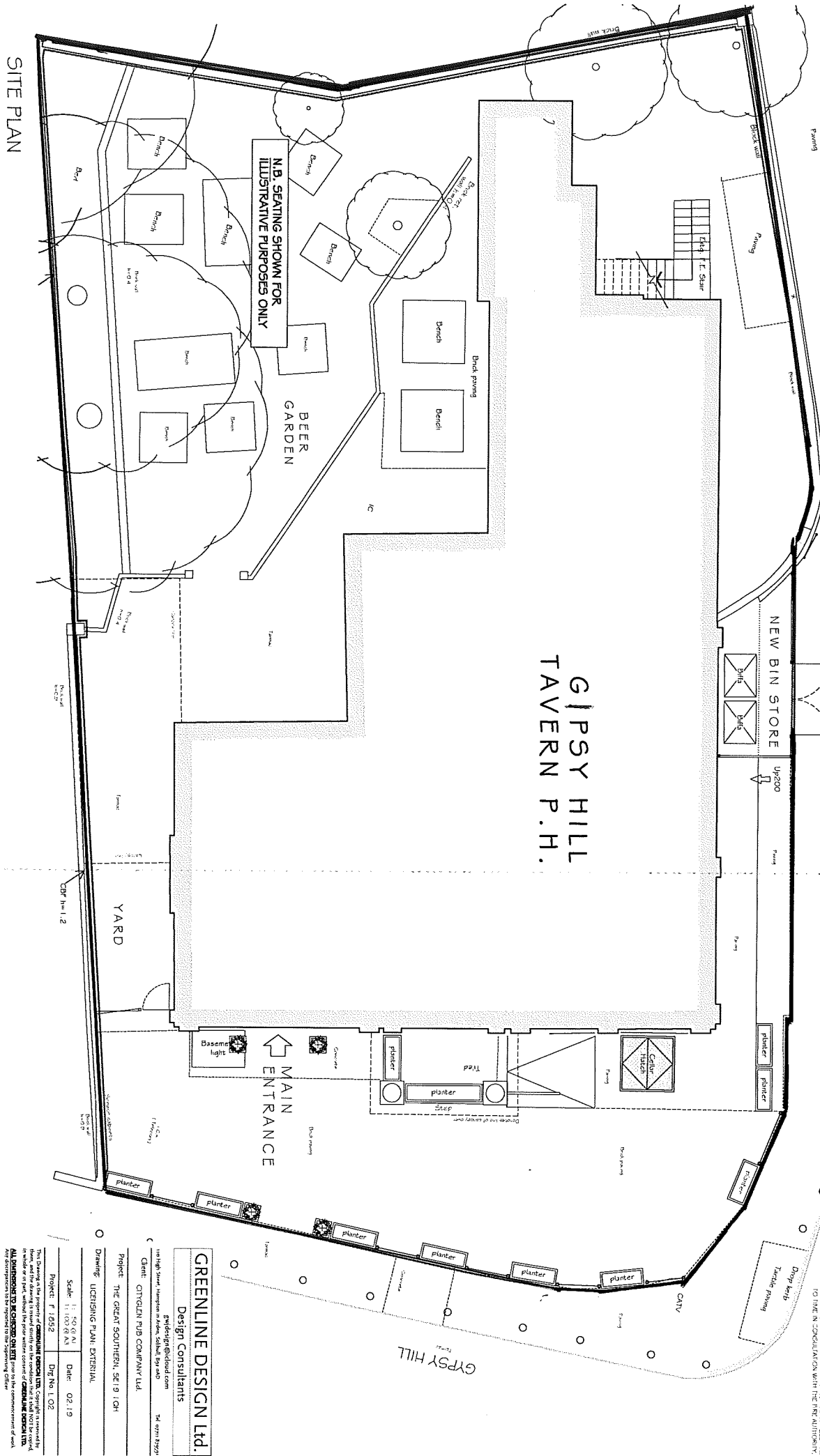

SITE PLAN

GREENLINE DESIGN Ltd.

Design Consultants

110 High Street, Tunbridge Wells, Kent, TN11 9AA
Tel: 01892 339991

Client: GYPSY HILL TAVERN P.H. COMPANY LTD.

Project: THE GREAT SOUTHERN, SCL19 10H

Drawing: LICENSING PLAN EXTERNAL

Scale: 1:1000

Date: 02.19

Project No: L02

Drawn By: [Name]

Checked By: [Name]

Approved By: [Name]

Notes: [Notes]